

High-performance packer



FOLDING-GLUING | PERIPHERAL | FOLDING CARTON

CARTONPACK 4

At a glance

Empowering flexibility

BOBST

CARTONPACK 4 automatically fills your shipping containers with folded and glued cartons. All settings and movements are motorized and MATIC for repeated box orders. This standardized equipment allows you to reduce your production costs while substantially increasing the productivity of your folder-gluer line.

CARTONPACK 4

- > At a glance
- > Packaging market
- > Benefits and features
 - > 1-3
 - > 4-5
- > Specifications 
 - > Measurements
 - > Technical information
- > Services
 - > General services
 - > BOBST Connect

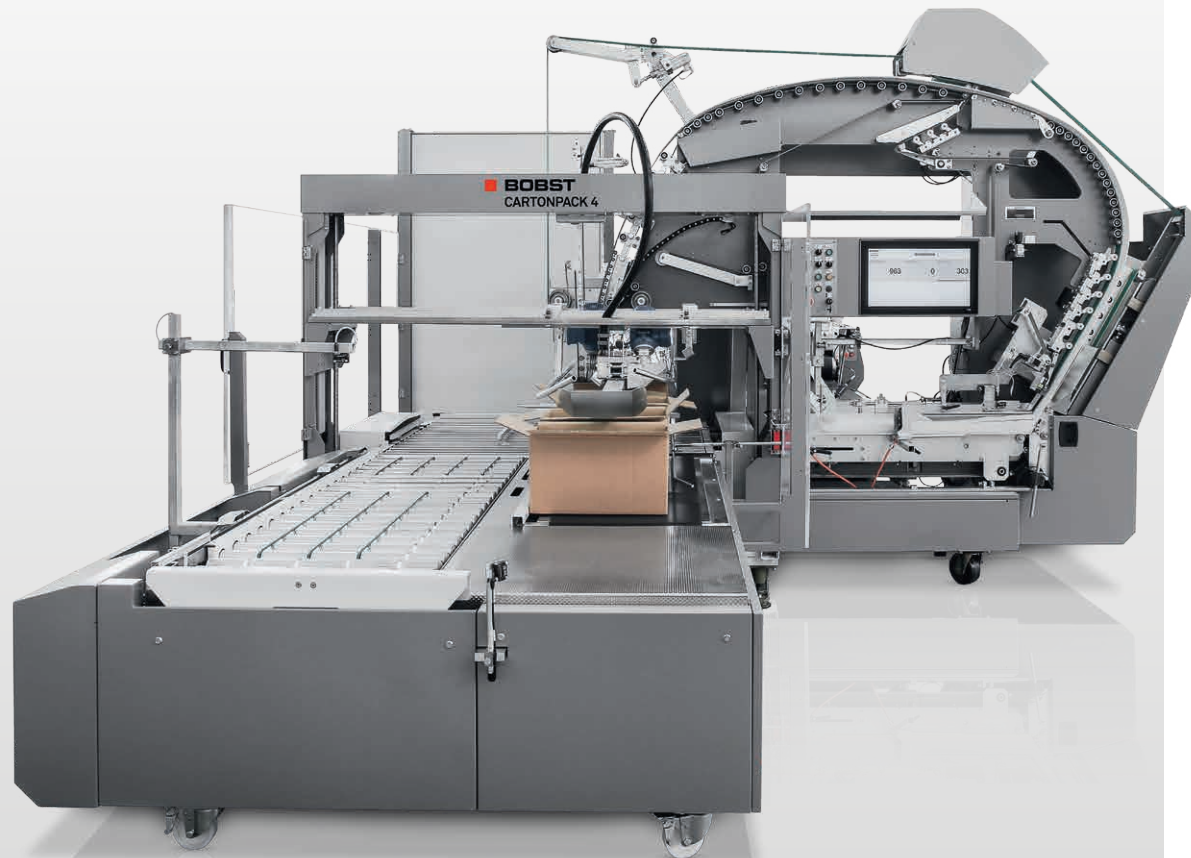

Keeping up
with the flow

Optimized
production costs

Impeccable quality
for your customers

**REQUEST
CONSULTING**

 Print responsibly

Data is not binding.
Non-contractual pictures.
The manufacturer reserves
the right to make
modifications without notice.
© BOBST SA 2022
BUPC-CP4-EN-1224

Creating value

BOBST innovations
are driven by customer
and brand owner needs.

[> READ MORE](#)

Functional packaging and protection

Protecting the goods in a clever way is required. Single serve, multi-packs, re-sealable, see-through.

Customization, versioning, personalization

Packaging needs to reach all segments of the society taking almost any shape and size from very short runs to reprint and long runs. All with the best color consistency.

E-commerce & omni-channels

Multiple retail formats set new requirements for packaging. On-demand production, timely delivery across multiple designs, shapes and sizes.

Sustainability

Packaging production needs to reduce its environmental carbon footprint – less waste across the entire supply chain. New and thinner substrates. Recycling and re-use are the new rules.

Faster time-to-market

A growing number of products need to reach consumers faster. Product lifetime is shorter. From product design to the consumer experience, the supply chain has to be more agile.



CARTONPACK 4

- > At a glance
- > Packaging market
- > Benefits and features
 - > 1-3
 - > 4-5
- > Specifications
 - > Measurements
 - > Technical information
- > Services
 - > General services
 - > BOBST Connect

Print responsibly

Data is not binding.
Non-contractual pictures.
The manufacturer reserves
the right to make
modifications without notice.
© BOBST SA 2022
BUPC-CP4-EN-1224



Multiple possibilities

Diversity

- Packing of a wide range of narrow and high box sizes, up to 6 rows and 8 layers
- Packing on the crease or on the closing flap
- Handles up to 200,000 b/h



Reduced workload

Ergonomics

- User-friendly work table with optimized access
- Easy circulation and removal of containers
- Excellent insertion of narrow and high containers
- Option for storing parameters in the BOBST Human Machine Interface (HMI)



High reliability

Quality and precision

- Minimum compression to avoid marking
- Highly accurate box counting
- Sampler allows periodic removal of boxes maintaining the correct number
- Save and repeat packing settings

CARTONPACK 4

- > At a glance
- > Packaging market
- > Benefits and features
 - > 1-3
 - > 4-5
- > Specifications
 - > Measurements
 - > Technical information
- > Services
 - > General services
 - > BOBST Connect

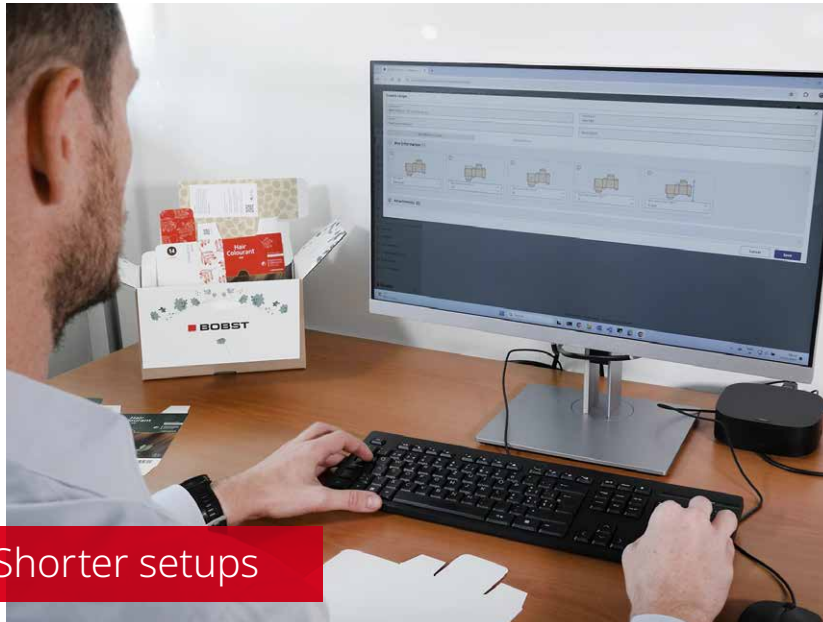

Shorter setups

Job and Recipe Management Workflow

Connects the HMI SPHERE via the BOBST Connect platform directly to the back office, where job recipes can be managed away from the production floor. Then, the job recipes are sent to the production lines and equipments, ready to be downloaded.

This system allows to increase uptime and proactively prepare shifts. Taking into account changes occurring during production, it ensures production consistency and continuous improvements across different shifts and operators. Via BOBST Connect, it provides a real-time follow-up of the packaging production progress and gives insights into production data.



Fully automated banding

Inline banding solution

A flexible solution, compatible with different banding systems and set up within 5 minutes on the CARTONPACK 4 via the HMI. The system allows to band up to 80,000 boxes per hour at the end of the folding-gluing line, taking advantage of the capacities of the CARTONPACK 4. The banding solution increases the production line productivity and considerably reduces manual labor.

At the filling stations, even uneven and slippery straight-line or 4&6-corner boxes boxes can easily be transferred into packaging lines, increasing process efficiency and preserving box quality.

CARTONPACK 4

- > At a glance
- > Packaging market
- > Benefits and features
 - > 1-3
 - > 4-5
- > Specifications
 - > Measurements
 - > Technical information
- > Services
 - > General services
 - > BOBST Connect

 Print responsibly

Data is not binding.
Non-contractual pictures.
The manufacturer reserves the right to make modifications without notice.
© BOBST SA 2022
BUPC-CP4-EN-1224

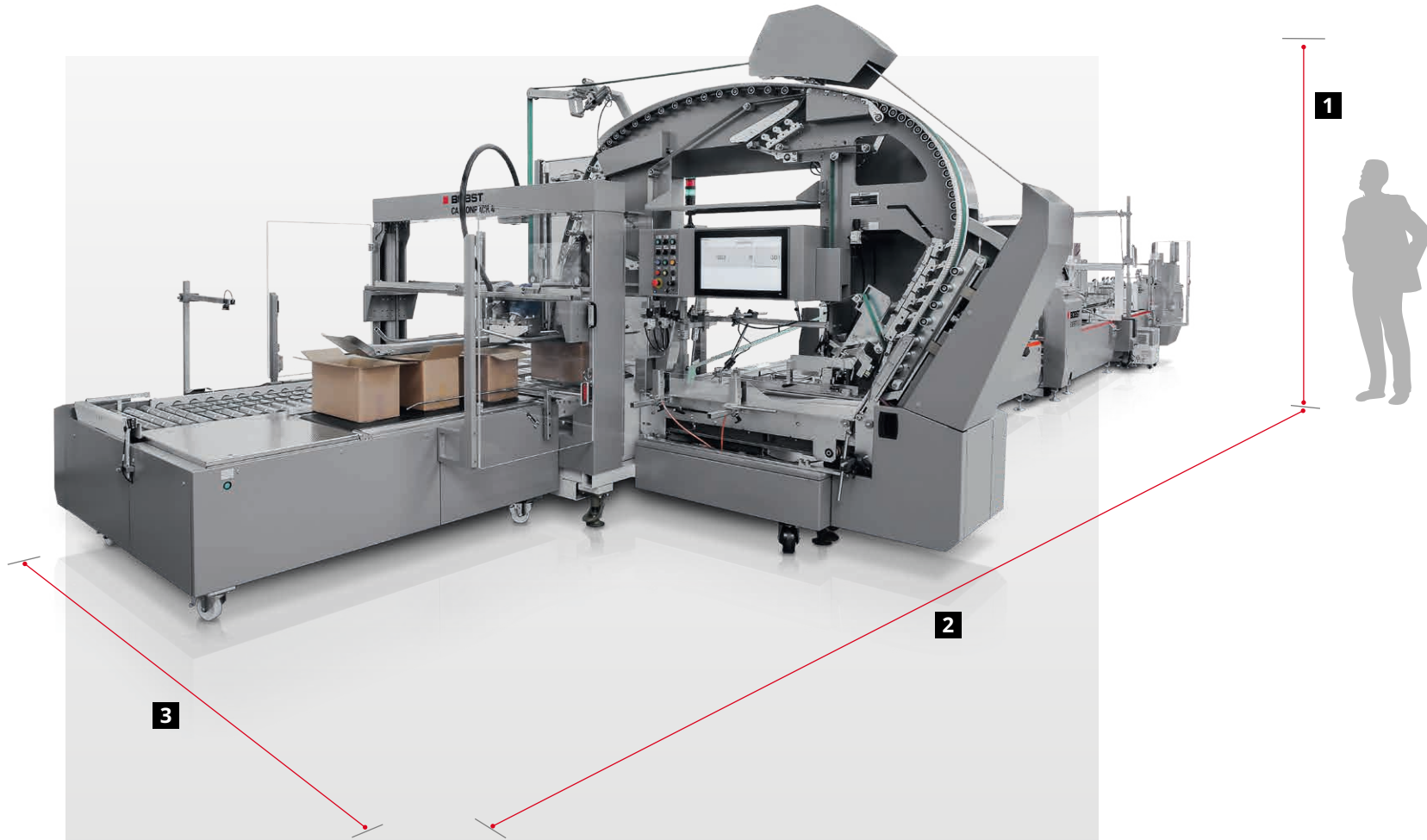

CARTONPACK 4

- > At a glance
- > Packaging market
- > Benefits and features
 - > 1-3
 - > 4-5
- > Specifications
 - > Measurements
 - > Technical information
- > Services
 - > General services
 - > BOBST Connect

1

2.75 m 9.02 ft

2

4.15 m 13.61 ft

3

3.85 m 12.63 ft

Print responsibly

Data is not binding.
 Non-contractual pictures.
 The manufacturer reserves
 the right to make
 modifications without notice.
 © BOBST SA 2022
 BUPC-CP4-EN-1224

Sizes PACKING ON THE CREASE

Boxes	mm	inch
C	90 - 550	3.54 - 21.65
E	40 - 380	1.57 - 14.96
L	min. 50	min. 1.96

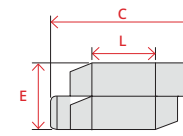

Containers	mm	inch
L	300 - 650	11.81 - 25.59
W	160 - 600	6.29 - 23.62
H	100 - 500	3.93 - 15.74

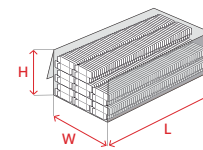

PACKING ON THE CLOSING FLAPS

Boxes	mm	inch
C	90 - 300	3.54 - 11.81
E	100 - 300	3.93 - 11.81
L		

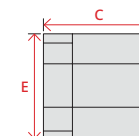

Containers	mm	inch
L	300 - 650	11.81 - 25.59
W	160 - 600	6.29 - 23.62
H	100 - 500	3.93 - 15.74

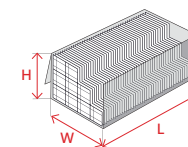

Convertible stock

Solid board	200 - 700 g/m ²	.010 - .036 in
-------------	----------------------------	----------------

Box types

Straight-line boxes
4 & 6-corner (subject to design)

Capacity

Production, up to	200,000 b/h
Number of rows per container	up to 6
Number of layers per container	up to 8

CARTONPACK 4

- > At a glance
- > Packaging market
- > Benefits and features
 - > 1-3
 - > 4-5
- > Specifications
 - > Measurements
 - > Technical information
- > Services
 - > General services
 - > BOBST Connect

REQUEST CONSULTING

Print responsibly

Data is not binding.
Non-contractual pictures.
The manufacturer reserves the right to make modifications without notice.
© BOBST SA 2022
BUPC-CP4-EN-1224

Maintaining excellence

Expert services for all your equipment. Improve your processes, boost your productivity and enhance your expertise with a complete range of services from BOBST.



Maintenance Plus

- Scheduled maintenance with BOBST certified technicians
- Preventative intervention, maximizing machine uptime
- Optimum performance over the equipment lifetime

[> WATCH VIDEO](#)

Approved parts and logistics

- BOBST Original and Certified parts, and consumables
- Quality assurance, and extended maintenance intervals
- Worldwide distribution, and full availability where and when you need it

[> LEARN MORE](#)

Machine upgrades

- Additional features, configured for your machine
- Enhanced functionality, connectivity and capability
- Future-proofing your investment, maintaining competitive advantage

[> LEARN MORE](#)

CARTONPACK 4

- > At a glance
- > Packaging market
- > Benefits and features
 - > 1-3
 - > 4-5
- > Specifications
 - > Measurements
 - > Technical information
- > Services
 - > General services
 - > BOBST Connect

Print responsibly

Data is not binding. Non-contractual pictures. The manufacturer reserves the right to make modifications without notice. © BOBST SA 2022 BUPC-CP4-EN-1224

Digital age manufacturing happening with BOBST Connect

BOBST Connect is an end-to-end, user-centric digital platform that enhances and increases your packaging productivity. It's designed to help you make the most of the data your machine generates, improving efficiency across your value chain.

As well as exceptional data insights, BOBST Connect helps to orchestrate and improve your whole production process, from your PDF to the finished product and quality report. It brings data and digital services together in one fully connected platform, with machine insights and expertise built in.

All of this is available to you as part of BOBST Connect Essential, the first subscription level that you receive when you purchase a new BOBST machine.



Performance analysis

- Production insights, including interaction of OEE components
- Identify and eliminate performance gaps

Accurate reporting

- Meaningful insights on OEE and downtime
- Accurately measure target speed and quality losses
- Trend analysis over time

Progress indicator

- Highlights extensive production deviations
- Empowers timely interventions

Remote assistance

- Priority access to technical specialists
- Video with Augmented Reality expert support based on real-time data
- Available 24/7 (optional)

Shift management

- Optimize planning time
- Deliver overall resource efficiency

CARTONPACK 4

- > At a glance
- > Packaging market
- > Benefits and features
 - > 1-3
 - > 4-5
- > Specifications
 - > Measurements
 - > Technical information
- > Services
 - > General services
 - > BOBST Connect

 Print responsibly

Data is not binding.
Non-contractual pictures.
The manufacturer reserves the right to make modifications without notice.
© BOBST SA 2022
BUPC-CP4-EN-1224

High-performance packer

WWW.BOBST.COM/CARTONPACK-4



CARTONPACK 4

- > At a glance
- > Packaging market
- > Benefits and features
 - > 1-3
 - > 4-5
- > Specifications
 - > Measurements
 - > Technical information
- > Services
 - > General services
 - > BOBST Connect

**REQUEST
CONSULTING**

 Print responsibly

Data is not binding.
Non-contractual pictures.
The manufacturer reserves
the right to make
modifications without notice.
© BOBST SA 2022
BUPC-CP4-EN-1224